

BROMLEY ESTATES

Marbella

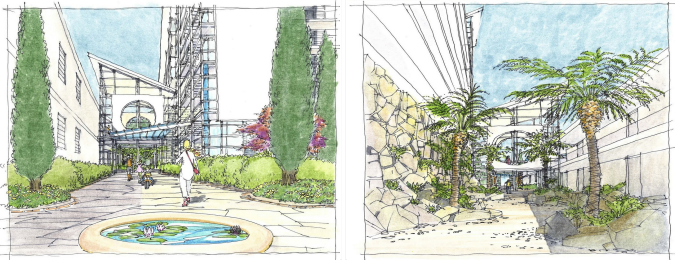
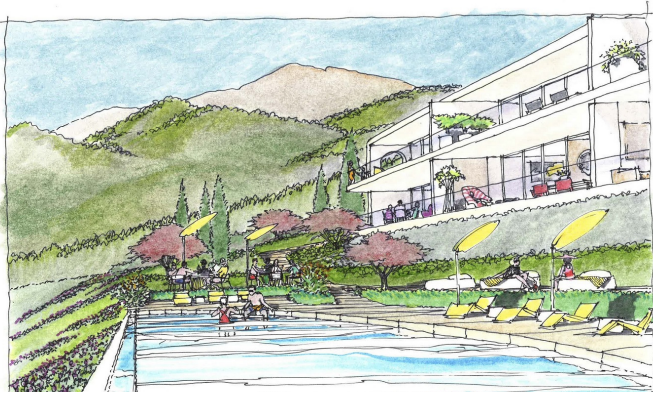

EXCLUSIVE CONTEMPORARY SOUTH FACING BENALMADENA APARTMENTS WITH PANORAMIC SEA VIEWS

📍 El Higueron

REF# BEMD1381 €895,000

BEDS

2

BATHS

2

BUILT

113.0 m²

TERRACE

29.0 m²

These highly exclusive contemporary apartments in Benalmadena offer the full package; they are part of one of the Costa del Sol's most prestigious resorts – Reserva del Higuero. The development is ideally located just 450m from the beach and the onsite facilities cannot be bettered; sports club, paddle and tennis courts, swimming pools, Spa, restaurants including SOLLO (Michelin starred) and a range of additional services available at the Hilton hotel.

The development is perfectly placed for anyone looking for an investment, holiday home or a rental property. Benalmadena – famed for its award winning fairy tale marina – is situated between Malaga and Marbella, just a short 20 minute drive from Malaga airport. The area is extremely popular with beach lovers and golfers. It has an international feel and offers a wide range of family friendly amenities and opportunities for outdoor activities.

+34 952 939 460 · info@bromleyestatesmarbella.com Urbanizacion El Rosario, CN340, Km 188, Marbella, Malaga 29603

BROMLEY ESTATES

Marbella

The architects have incorporated their love of the coast and undulating waves within the curves of the roof and colour of the façade. When you step into the reception area of these stunning contemporary apartments in Benalmadena, you will be struck by the majesty of the double height ceilings and sculptures (by Portuguese artist Rogerio Timoteo). Similarly all communal areas are presented in a tasteful style and comfortably furnished. Onsite amenities include Jacuzzis, infinity pools with views towards Fuengirola, and even a business centre.

It's all about the lifestyle, placing equal importance on the interior living space and outdoor facilities. These superb contemporary benalmadena apartments are available in a choice of 2 or 3 bedrooms and there is also a selection of 4 bedroom penthouses with super stylish contemporary bathrooms. The living rooms are open plan and join seamlessly with the outdoor space through large patio doors, affording unfettered views across the Mediterranean. The large windows bathe the interior in sunlight, whilst pale natural wood floors add to the sense of space and add further texture. Penthouses have their own mini hot tubs and panoramic sea views. Each property comes with 2 parking spaces and a lockable store room.

If you would like to enjoy a 5-star lifestyle as the owner of one of these exclusive contemporary sea facing Benalmadena apartments, call us to arrange a private viewing.

Prices starting from 369,000 Euros to 695,000 Euros