

# BROMLEY ESTATES

*Marbella*



## RESIDENTIAL PLOT BEDROOMS BATHROOMS IN BENALMADENA

📍 Benalmadena

REF# BEMR3802513 €160,000

BEDS

BATHS

BUILT

PLOT

m<sup>2</sup>

672 m<sup>2</sup>

OPPORTUNITY. Urban land in Benalmádena. Plot surface: 672 m<sup>2</sup>. Building coefficient: 0.25%. Maximum building area: 168 m<sup>2</sup> of buildable roof. Urban use: Detached single-family housing. Located in the Santangelo Norte Urbanization, next to the AP-7 above Arroyo de la Miel, 6 km from the town center. It has all the services at the plot, such as electricity, water, telephone, sanitation, public lighting, etc. Magnificent views and orientation. Don't hesitate, take advantage of this opportunity and carry out the project you always dreamed of at a truly unique price. SALE SUBJECT TO 21% VAT.

Residential Plot, Benalmadena, Costa del Sol.  
Garden/Plot 672 m<sup>2</sup>.

Setting : Close To Golf, Urbanisation.

Orientation : South.

Views : Sea, Mountain.

Utilities : Electricity, Drinkable Water, Telephone

+34 952 939 460 · info@bromleyestatesmarbella.com Urbanizacion El Rosario, CN340, Km 188, Marbella,  
Malaga 29603

# BROMLEY ESTATES

*Marbella*

Category : Bargain, Cheap, Investment, Reduced, With Planning Permission.

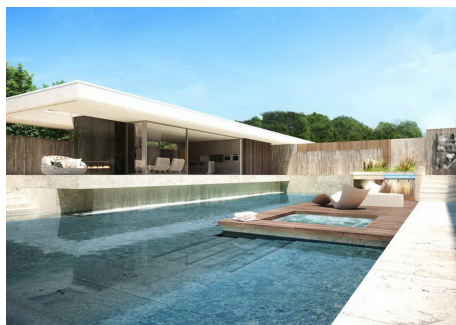
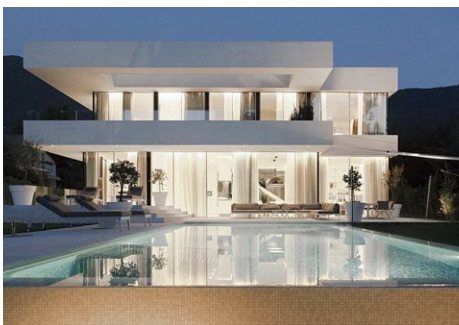
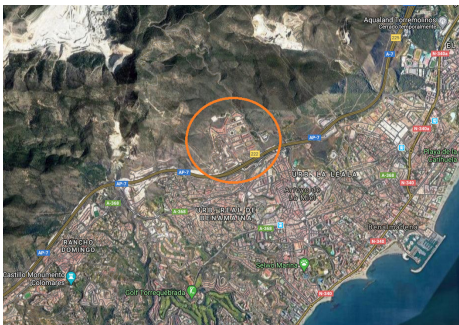
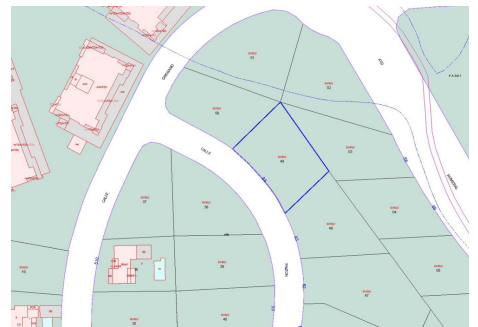
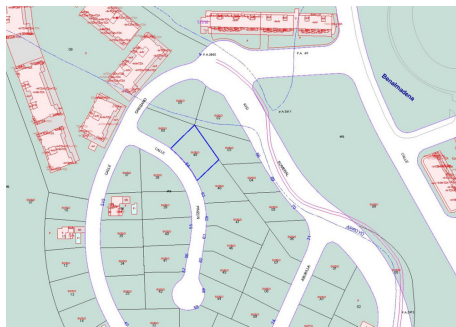
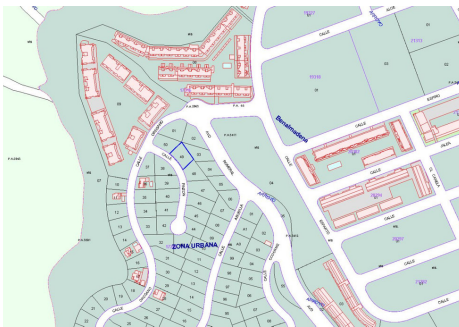
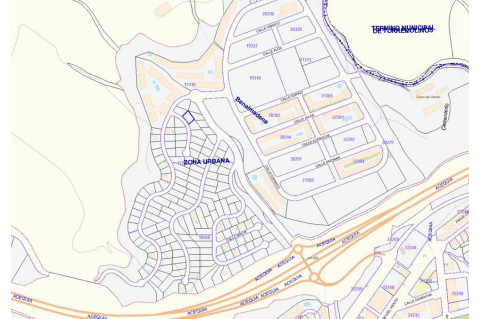

+34 952 939 460 - [info@bromleyestatesmarbella.com](mailto:info@bromleyestatesmarbella.com) Urbanizacion El Rosario, CN340, Km 188, Marbella, Malaga 29603