

BROMLEY ESTATES

Marbella

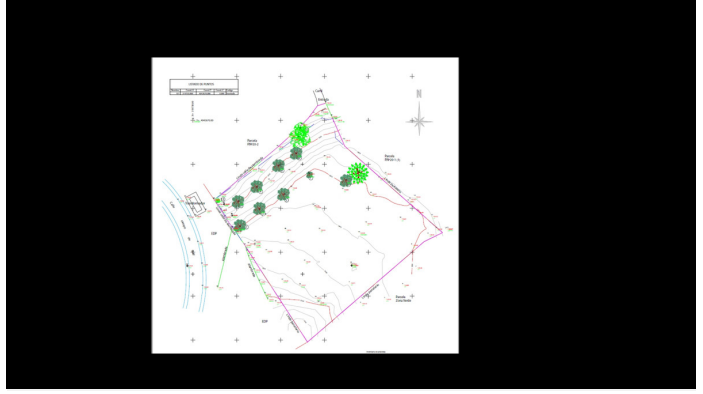

RESIDENTIAL PLOT BEDROOMS BATHROOMS IN BENAHAVIS

📍 Benahavis

REF# BEMR3805150 €1,200,000

BEDS

BATHS

BUILT

PLOT

1000 m²

5185 m²

BEST PRICED LAND IN THE MARKET – 222 €/Sqm – Plot in Puerto del Almendro, Benahavis – Marbella

Flat plot of 5.186 sqm. – Situated in an ideal position for people who want peace and tranquility – Panoramic views over the surrounding landscape – Partial sea view as well – The commercial centre of Monte Falcones is just around the corner and offers basic amenities such as supermarket, pharmacy, restaurants etc. – Further amenities is found in San Pedro and Puerto Banus, only 10 min. away.

The urbanization has barriers and camera at the entrance as well as a tennis court available to residents.

For construction of villa – Edif. 20 pct. min. plot 3.000 sqm. – Very tranquil and idyllic location – open views and very private – Sea views from second floor.

BROMLEY ESTATES

Marbella.

Approved project available – see renders. We have the neighboring plot of 4.300 sqm. for sale as well, hence total of more than 9.300 sqm. is available.

Arguably one of the best opportunities for a plot of land for the construction of a villa – and more so as it is in a gated community in Benahavis – Doesn't get much better.



BROMLEY ESTATES

Marbella

