



## GROUND FLOOR APARTMENT 2 BEDROOMS 2 BATHROOMS IN MIJAS

📍 Mijas

REF# BEMR4248535 €517,000

BEDS

2

BATHS

2

BUILT

80 m<sup>2</sup>

TERRACE

21 m<sup>2</sup>

New Development: Prices from €517,000 to €1,119,000. .

Unique residential complex where you can relax and enjoy life to the fullest. Quality, nature, comfort and innovation are the principles that guide and inspire the design of 50 apartments divided into 3 construction phases.

Enjoy a prime location in the mountains of Mijas with the beaches of Fuengirola as a background.

– Located by nature: nature and tranquility, while at the same time providing the possibility to enjoy all kinds of services within a 10 minute radius by car.

– Outlined by nature: With the most desirable orientation on the Costa del Sol, south-west facing, the development offers exclusive 2 and 3 bedroom apartments. In the design of the buildings, the focus has been on privacy, incorporating hanging gardens that fall down the facade as a green-waterfall. This creates lush privacy walls and brings a total integration with the surroundings to the overall vision of the project.

+34 952 939 460 · [info@bromleyestatesmarbella.com](mailto:info@bromleyestatesmarbella.com) Urbanizacion El Rosario, CN340, Km 188, Marbella, Malaga 29603

– Homely by nature: The apartments are flooded with natural light, creating a warm and welcoming atmosphere. The interior design empowers the heart of the homes by offering a spacious open-plan living and dining area.

– Concept by nature: a unique project based on nature that will become a landmark of real estate in Mijas.

Exclusive Customization Program, each home is unique, meeting the tastes and needs of its owners. Thanks to our rich catalog of choices of finishes, homeowners can find different options for flooring and tiling, fittings and toilets, as well as different finishes for kitchen furniture and extras to give the apartment a touch of distinction.

The landscaped areas and hanging gardens envelop the private amenities:

- Outdoor infinity pool.
- Separate children's pool.
- Wellness area with sauna, turkish bath and fully equipped functional training area.

Contact our team now for more information and start living in a born by nature place.

Information about the area

Malaga airport: 25km / 20 min. by car. Supermarket/grocery: 3km / 5 min. by car. Restaurants: 1km / 5 min. by car. Beach: 5km / 10 min. by car.

What's nearby?

- Jardines De La Muralla 900 m
- Plaza de Toros Mijas 950 m
- Mirador Jesús Jaime Mota 1,1 km
- Plaza Virgen de la Peña 1,2 km
- Fuente De La Seda Park 1,2 km
- Osunillas Park 2,4 km
- Olisol Park 3,5 km
- Plaza Maite Alcazar 3,7 km
- Vicente Aleixandre Park 3,8 km
- Antonio Machado Park 3,9 km

Restaurants and cafés

- Cafeteria/barCafeteria La Muralla 850 m
- Cafeteria/barCafeteria Virgen De La Pena 950 m
- Cafeteria/barPizzeria Oscar 950 m

Tourist Attractions

- Colomares Monument 6 km
- Plaza de España 6 km
- Plaza Costa del Sol 13 km
- Casa de los Navajas 13 km

Natural surroundings

- Sea/oceanCosta del Sol 4.9 km
- River Guadalmina 35 km

# BROMLEY ESTATES

## *Marbella*

### Beaches in the area

- Fuengirola Beach 3.8 km
- Los Boliches Beach 4.1 km
- Carvajal Beach 4,1 km
- Tajo de la Soga Beach 5 km
- La Morera Beach 5 km

### Public transport

- TrainTorreblanca 3,5 km
- TrainLos Boliches 4 km

### Nearest airports

- Malaga Airport 16 km

Distances may vary, they are made in a straight line. They are approximate

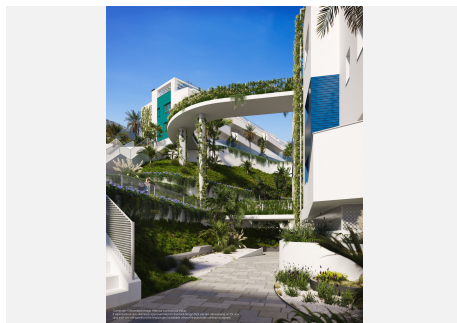
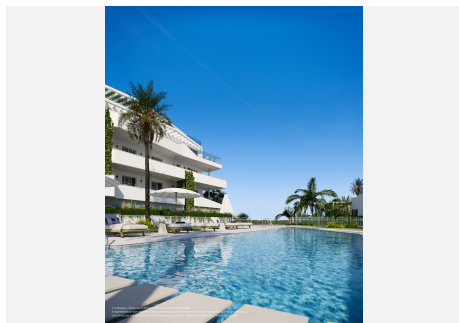



# BROMLEY ESTATES

*Marbella*

