

BROMLEY ESTATES

Marbella

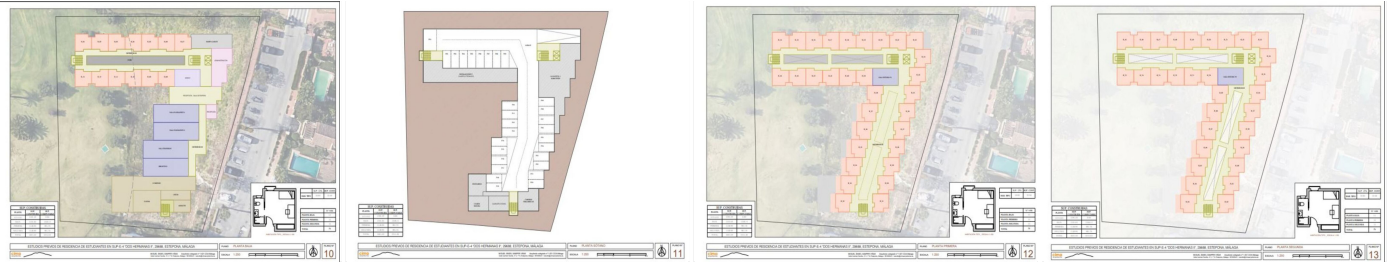

RESIDENTIAL PLOT BEDROOMS BATHROOMS IN ESTEPONA

📍 Estepona

REF# BEMR4600666 €1,750,000

BEDS

BATHS

BUILT

PLOT

m²

3212 m²

Located on a plot of 3,212 m², this land is classified as sectorized and planned urbanizable land, with a specific designation as a Community Equipment Zone. Designed for social benefit, its utilization and use are intended for social facilities, offering extraordinary potential for the development of enriching projects.

The maximum buildable surface of 3,212 m² allows for the realization of an ambitious vision that has been carefully studied. This land has been considered for three possible uses, each of which has been meticulously planned:

Senior Apartments: A proposal that includes assisted living units with a Day Center, fostering a safe and welcoming environment for the elderly.

Geriatric Residence: Designed with a hospital focus, this option offers facilities that meet the highest standards of care and comfort for the geriatric population.

+34 952 939 460 · info@bromleyestatesmarbella.com Urbanizacion El Rosario, CN340, Km 188, Marbella, Malaga 29603

