



HOUSE 6 BEDROOMS 7 BATHROOMS IN SOTOGRANDE ALTO

📍 Sotogrande Alto

REF# R4643614 €3,695,000

BEDS

6

BATHS

7

BUILT

600 m²

PLOT

3300 m²

TERRACE

432 m²

ECOLOGICAL PASSIVE VILLA IN SOTOGRANDE WITH PARTIAL VIEWS OF THE SEA

This property will be constructed on 1 floor with the highest specifications possible and consisting of; Entrance hall with wardrobe, huge living/dining room separated with kitchen wardrobes but still partly open. Through a distributor you go to the master bedroom with ensuite bathroom and dressing. In this part of the villa there is also another bedroom with ensuite bathroom.

The fully fitted kitchen with all appliances give out to a walled courtyard with a pergola terrace.

On the other side of the villa, we have a distributor with guest toilet, a huge garage, storage room, another distributor with 2 bedrooms with 2 bathrooms and 2 further bedrooms with ensuite bathroom.

Furthermore, there are several covered terraces, pergola terraces and terrace with a chill-out, heated swimming pool and an open garden storage.

Pictures of the bathrooms and kitchen are only examples final choice of the finishings shall be for the client within the chosen line that we propose.

+34 952 939 460 · info@bromleyestatesmarbella.com Urbanizacion El Rosario, CN340, Km 188, Marbella, Malaga 29603

BROMLEY ESTATES

Marbella

Example of some of the specifications,

- Interior and exterior floor tiles from GRESPANIA or LIVING CERAMICS
- Bathroom walls with COVERLAM or LIVING CERAMICS plates 2700X1200
- Bathrooms from ROCA – DURAVIT – VILLEROY BOCH – GEBERIT – HANS GROHE OR SIMILAR
- Aerothermia/airconditioning
- Electric underfloor heating in the bathrooms
- Hydraulic underfloor heating in living room, and bedrooms
- Ceiling high windows from Reynaers or similar with a sunken track, Planistar glass of 5+5/chamber/4+4
- Ceiling high pivot entrance door 1,50 wide
- Ceiling high and 1-meter wide interior doors
- Fully fitted kitchen with aluminum frame doors and covered with COVERLAM (Colour to choose)
- Island with COVERLAM 3600X1400 almost no visible joints
- White goods from Bosch or AEG
- Heated pool
- 24 solar panels
- 2 lithium batteries of each 10kW
- Car charger

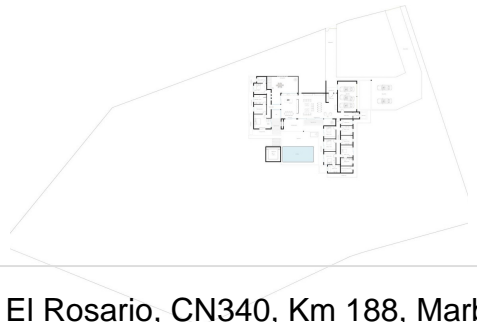
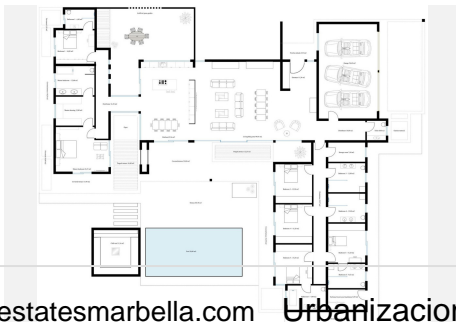
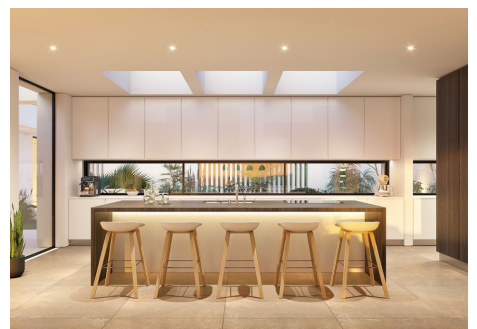

+34 952 939 460 · info@bromleyestatesmarbella.com Urbanizacion El Rosario, CN340, Km 188, Marbella, Malaga 29603