

## DUPLEX 2 BEDROOMS 2 BATHROOMS IN NUEVA ANDALUCIA

📍 Nueva Andalucia

REF# BEMR4699993 €425,000

BEDS

2

BATHS

2

BUILT

97 m<sup>2</sup>

TERRACE

14 m<sup>2</sup>

An elegant West facing 2 bed apartment in Aloha, walking distance to shops, restaurants and the new promenade that is coming soon.

Decorated in stylish manner that complements the unique style of the development, it is in an excellent condition and ready to move in. With an an open plan kitchen that leads onto a comfortable dining and living area. The living area opens up onto an elevated south west facing terrace that is perfect for the afternoon sun.

The 2 bedrooms and 2 bathrooms are both ensuite. Both bathrooms have been recently renovated in a modern yet elegant style, the main bedroom is at a slightly lower level than the living room and the guest bedroom slightly higher.

# BROMLEY ESTATES

*Marbella*

Constructed in a traditional Andalucian white style with a strong Moorish influence, it is located in the heart of one of the most exclusive residential areas of Aloha, Atalaya de Rio Verde.

A short walking distance from the shops and restaurants of Aloha, as well as Puerto Banus. The development is gated, has a lovely free form communal pool at its centre and is well maintained; only recently completely repainted.

The brand new walking promenade running along the Arroyo de Benabola, that goes from Aloha to Puerto Banus, starts only a few hundred metres from Pueblo Arabesque and will further enhance the value of this location.

The dimensions in the escritura are:

Constructed 97,06m<sup>2</sup> plus 14.40m<sup>2</sup> terrace

Details are correct to the best of our knowledge but subject to verification.

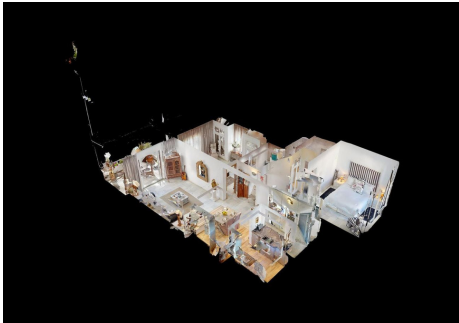

# BROMLEY ESTATES

*Marbella*

